

# Cut, Stitch and Join

## Everyday fabric products

Many home products are made from fabric, including tea towels, pillowcases, cushions, tablecloths and peg bags.

## Cath Kidston

Cath Kidston is a British textile and homeware designer. She founded the Cath Kidston brand.



Cath Kidston prints are based on traditional patterns.

They have bright, colourful designs with spots, stripes, flowers and other motifs.



## Sewing patterns

A sewing pattern is a template of the parts needed to make a product. Sewing patterns are usually made from paper. This is a sewing pattern for a bag tag.

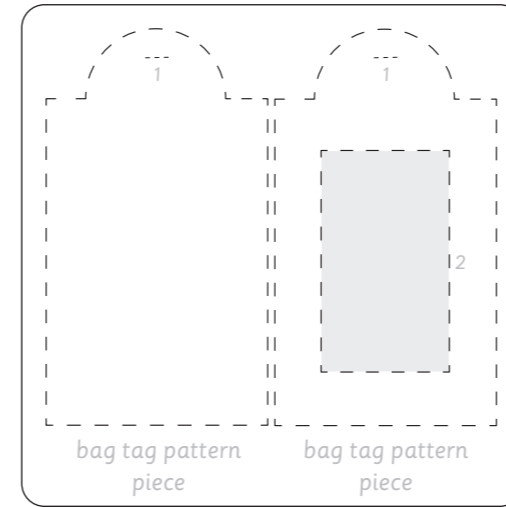

## Stitching

A running stitch is a basic stitch used to join fabric. It is made by passing a needle and thread in and out of the fabric. Binca or Aida fabric is useful for practising stitches.

1. Thread the needle and tie a knot in the end of the thread. Push the needle through the fabric and pull the thread through.
2. Miss a hole in the fabric and then push the needle through the fabric again. Pull the thread to make a stitch. Repeat to make a row of stitches.
3. Tie a knot in the thread at the back of the fabric and cut off the thread to complete your stitching.

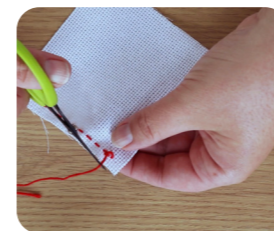
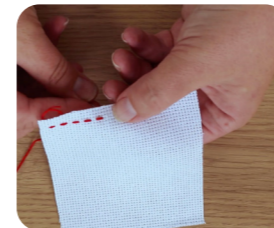
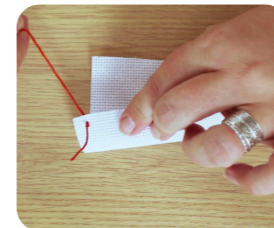

## Embellishment

Fabric products can be improved by making them easier to use, more hardwearing or more attractive. Embellishments including sequins, appliqué, buttons and printing can be used to decorate fabric.

Sequins can be glued onto the fabric.

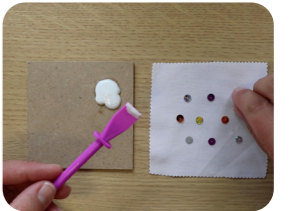

Appliqué embellishments can be sewn onto fabric.

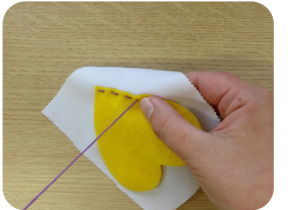

Buttons can be sewn onto fabric.



Motifs can be printed onto fabric.



## Glossary

|                 |  |
|-----------------|--|
| <b>appliqué</b> | Decorative needlework in which pieces of fabric are sewn or stuck onto a larger piece to form a pattern. |
| <b>motif</b>    | An image or design that can be repeated to create a pattern.   |
| <b>sequin</b>   | A small, shiny metal or plastic disc.  |
| <b>textile</b>  | A fabric made by hand or machine.  |